

PROPERTY FOR SALE



Selling Office

Forestland Consultants, Inc.

Jeff Pardue

P.O. Box 807

Wilkesboro, NC 28697

Office: 336-667-4424

Cell: 336-957-6011

www.ForestlandConsultants.com

Robert P. Laney
Rawhide Road Tract
Wilkes County, NC
MLS #918235
March 2020

Listed Price: \$ 33,000.00

Acreage: Approximately 10.0 Acres +/-

Deed Description: Deed Book 1088, Page 418

Property for Sale: All of the above described real property.

Tax Record Number: Parcel # 0801666

NC Pin Number: 3902-55-0140

2019 Tax Valuation: \$ 39,000.00

2019 Ad Valorem Taxes: \$ 304.20

Directions to property: From Millers Creek go north on NC Highway 16; turn left on White Oak Road; turn right on Shoe Road; turn right on Rawhide Road; at end of state maintenance turn left onto private gravel road and go about 1400 feet to subject property on left.

Land Description: 10 acre tract with building site, stream, timber, and plenty of peace and quiet. This lot is one of nine lots in a mountain subdivision that was developed in year 2000. There are two permanent residents in the subdivision, and other neighbors nearby.

Shoe Mountain Subdivision was developed at the turn of the century. This is a beautiful section of Wilkes County with mountains and rolling hills in every direction. The neighborhood is quiet and peaceful with most of the surrounding land being timberland. The land lies in the shadow of the Blue Ridge Parkway with easy access to Boone, West Jefferson, and Wilkesboro.

Buildings:

School Districts: Millers Creek Elementary
West Wilkes Middle School
West Wilkes High School

Fire District: Wilbar

Zoning:

Timber: Intermediate age timber stands with merchantable size trees, but needs a few more years to reach maturity. Predominantly hardwoods with some white pine.



LOCATION MAP



MLS #918235

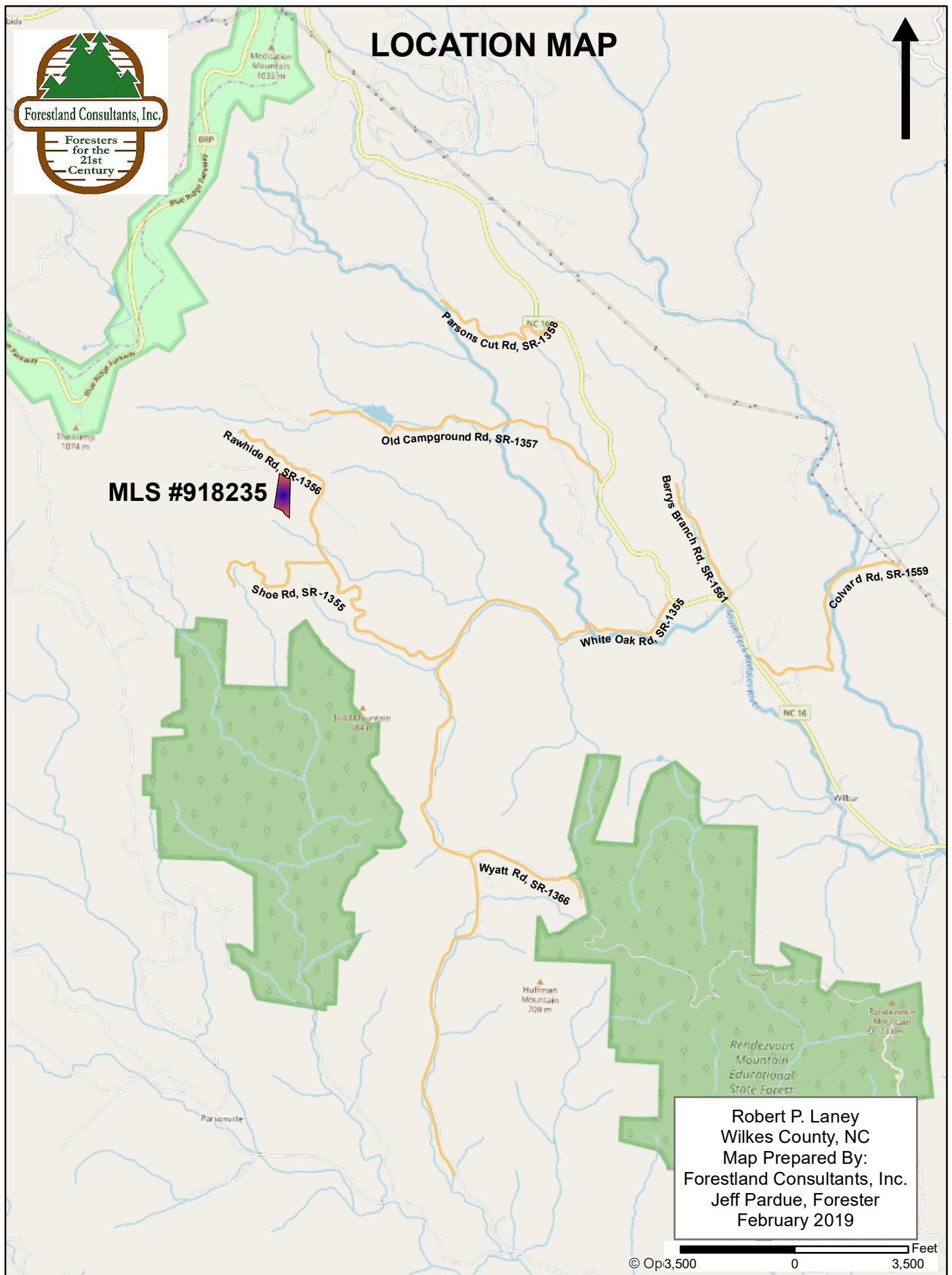

Robert P. Laney
Wilkes County, NC
Map Prepared By:
Forestland Consultants, Inc.
Jeff Pardue, Forester
February 2019



MLS #918235



Ravenshoe Rd. SR 1356

Robert P. Laney
Wilkes County, NC
Map Prepared By:
Forestland Consultants, Inc.
Jeff Pardue, Forester
February 2019

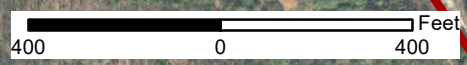



TOPOGRAPHIC MAP
MLS #918235

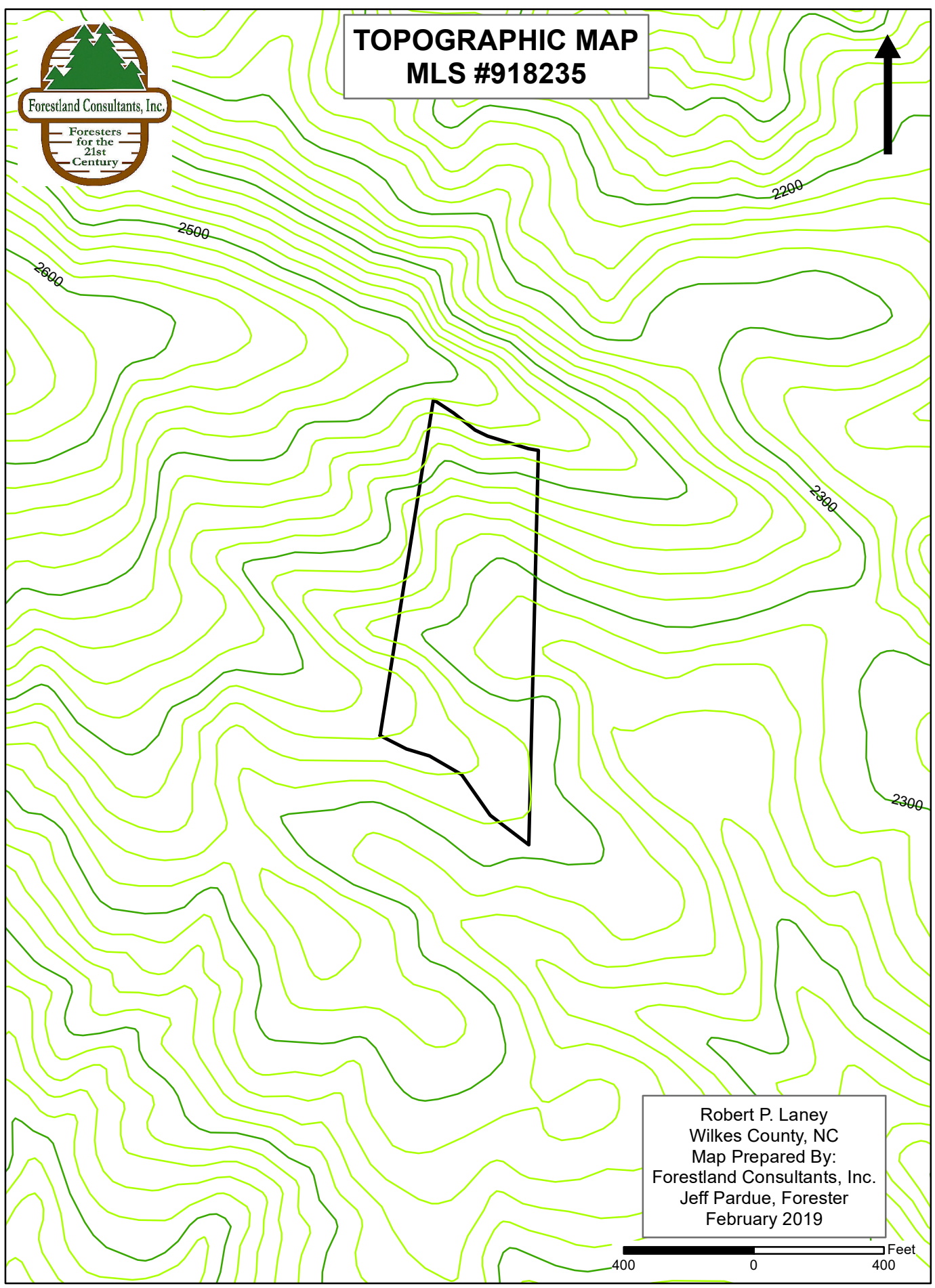

Robert P. Laney
Wilkes County, NC
Map Prepared By:
Forestland Consultants, Inc.
Jeff Pardue, Forester
February 2019

